

Planning Act 2008
ABLE Marine Energy Park
 NORTH LINCOLNSHIRE, NORTH EAST LINCOLNSHIRE, and EAST RIDING OF YORKSHIRE

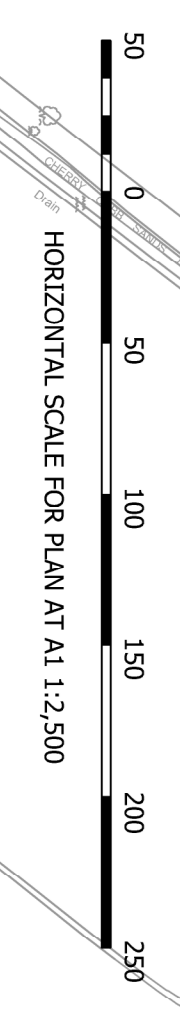

- KEY**
- Scheduled Monument
 - Listed Building Grade I
 - Listed Building Grade II
 - Listed Building Grade II*
 - Sunk Island - Conservation Area
 - Thornton Curles - Conservation Area
 - Barrow upon Humber - Conservation Area
 - iOE (Image of England Reference)
 - 00 English Heritage UID Reference

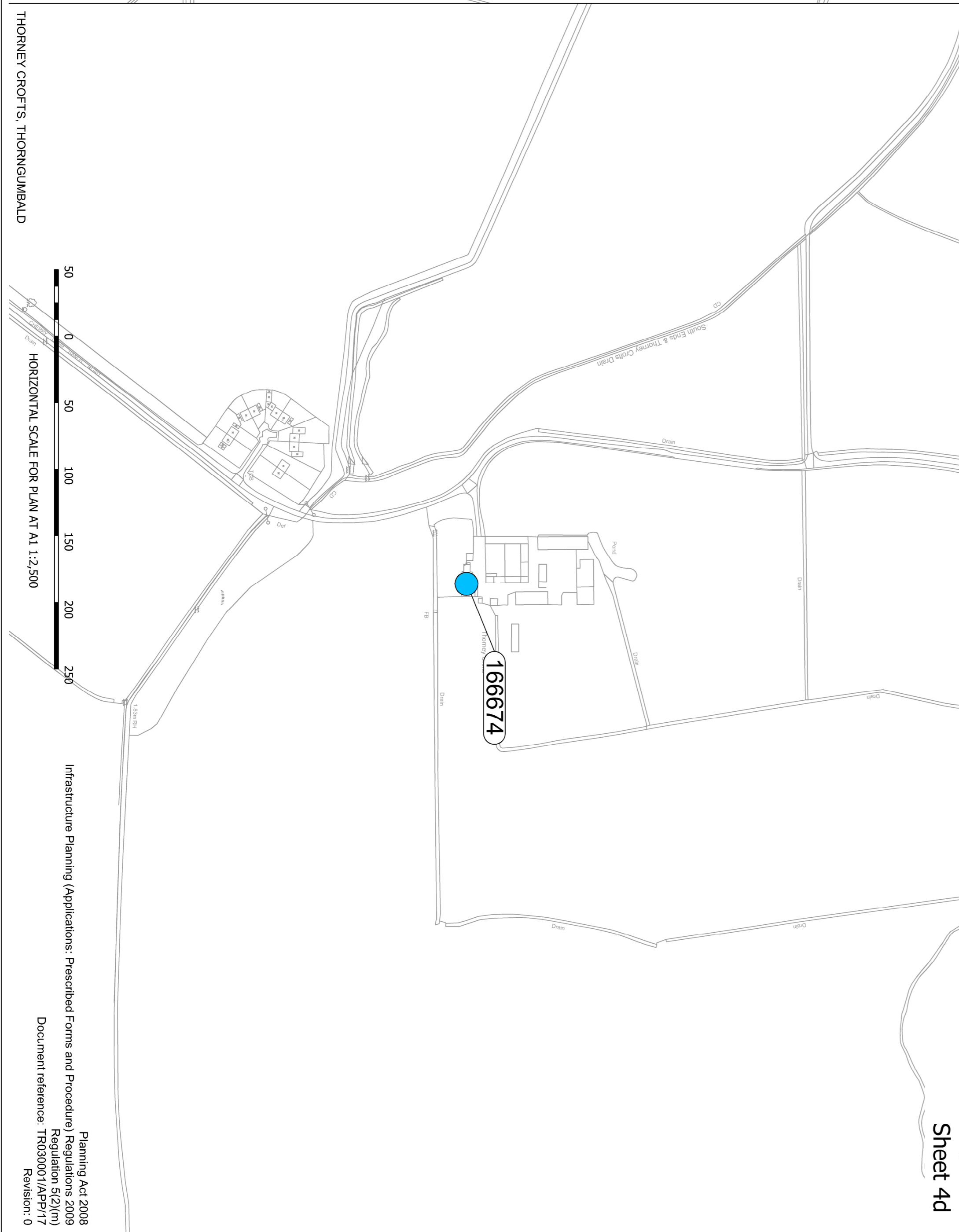
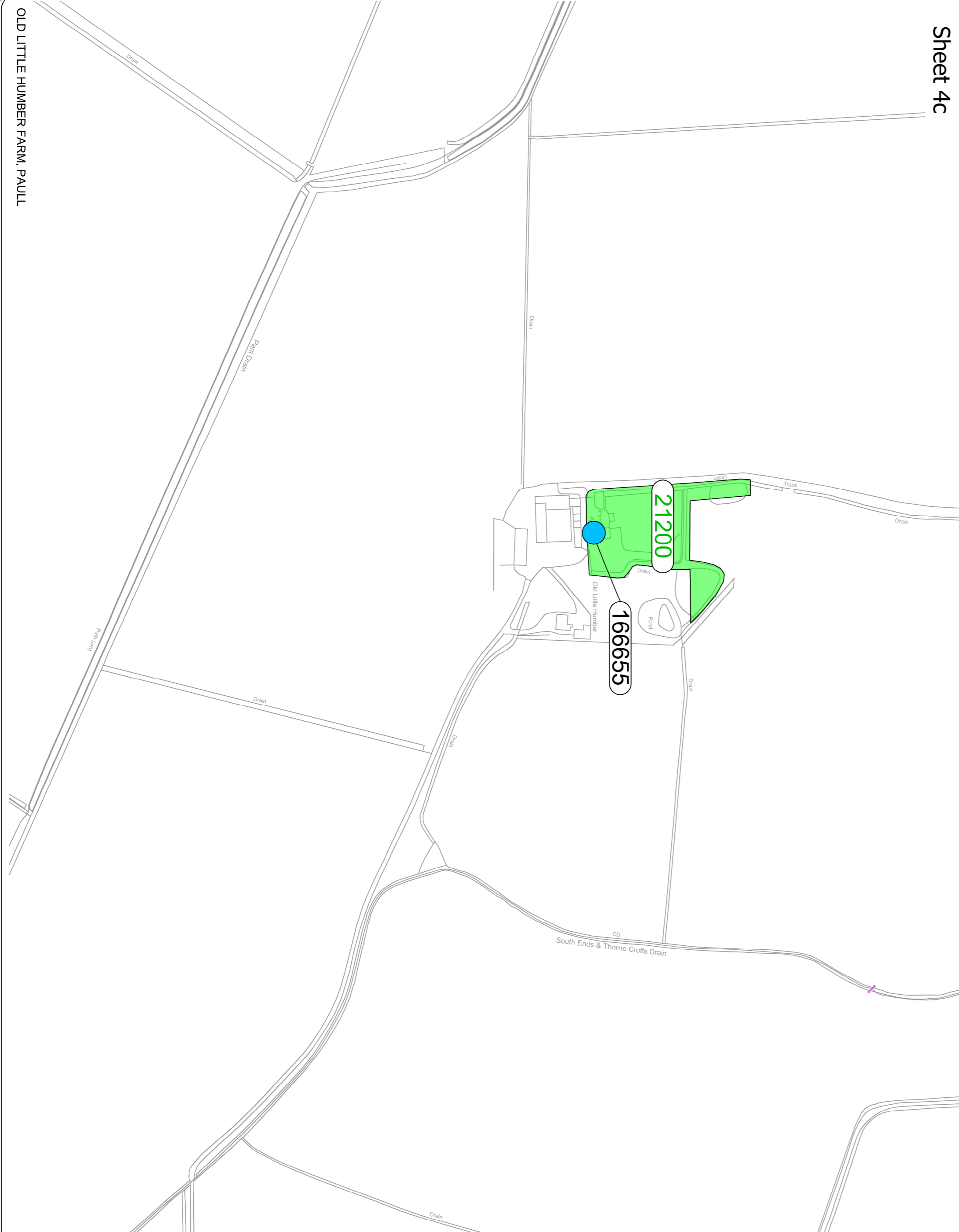
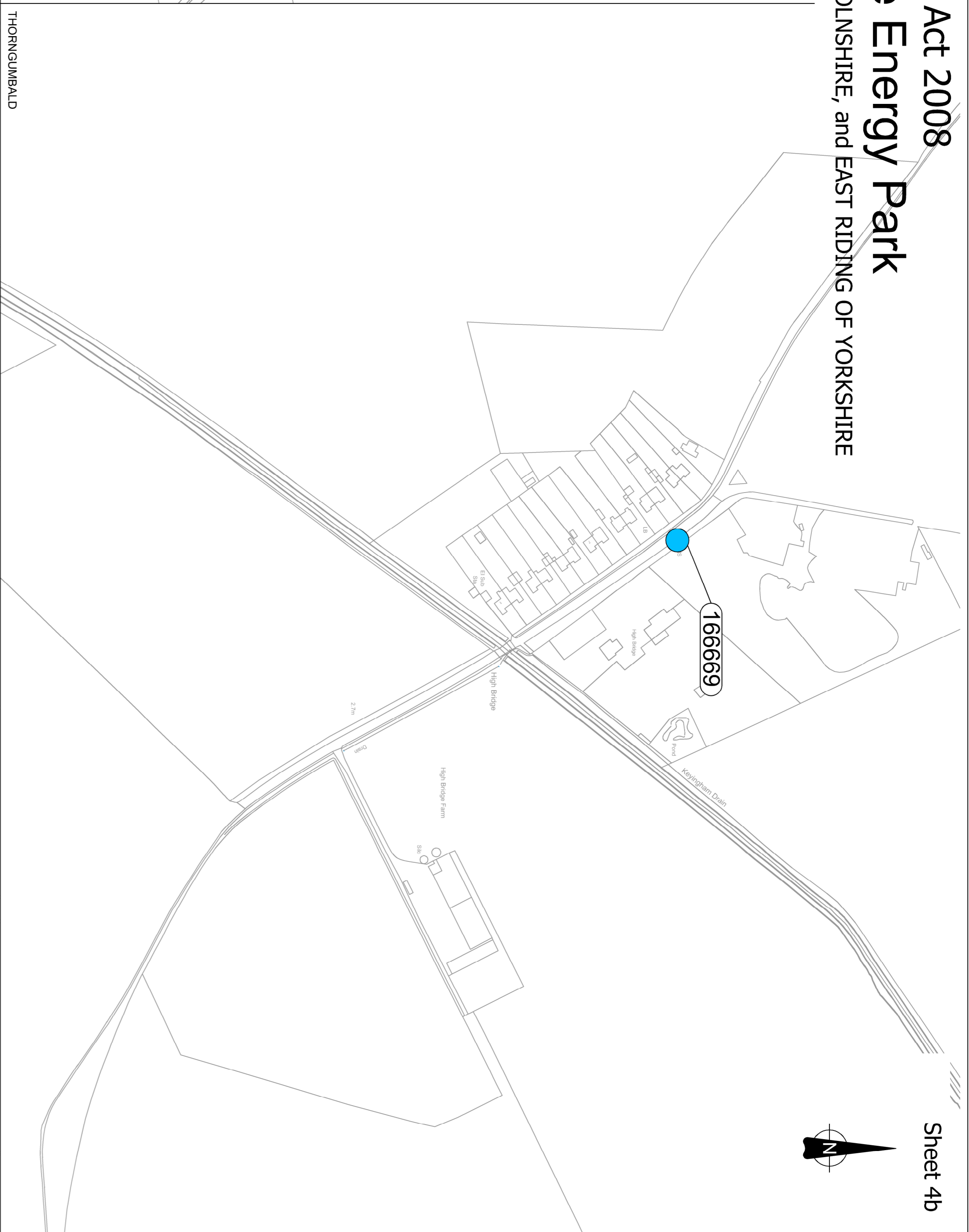

Infrastructure Planning (Applications: Prescribed Forms and Procedure) Regulations 2009
 Document references: TR032011, TR032012, TR032013
 Revision: 0

FOR APPROVAL

Scale	1:2,500@A1	Drawn	R Kahl	Checked	R Cam	Approved	R Cam
Date	19/05/2011	Revision	0				

Project: **ABLE Humber Pools Ltd**
 Client: **ABLE UK Ltd**
 Title: **Heritage Plan Sheet 4a,b,c,d**

ABLE UK Ltd
 2c, 44-45/101-102, 88-90
 Broomfield Road, Broomfield
 Salford, Greater Manchester
 M6 6PU
 Tel: 0161 275 1100
 Email: info@ableuk.com
 www.ableuk.com

Rev	Date	For Approval	Comments	Rev	CHK	APP
0	19/05/11					